



WMRC Series

WMRC (Transparent) Wheel Diameter × Wheel Width 75 x 31mm

EAN

KS-1202070313W173

Impact Resistance, Non-Marking, Not Be Dyed, Corrosion resistant, very Great Abrasion Resistance, Odorless Resistant to many chemicals, Heavy Load, very low Rolling Resistance Color: Natural, with Dust Cap

Wheel Tread: Thermoplastic (PA6)
Wheel Center: Thermoplastic (PA6)
Bearing: precision ball

Drawings are for reference only and may differ from the product

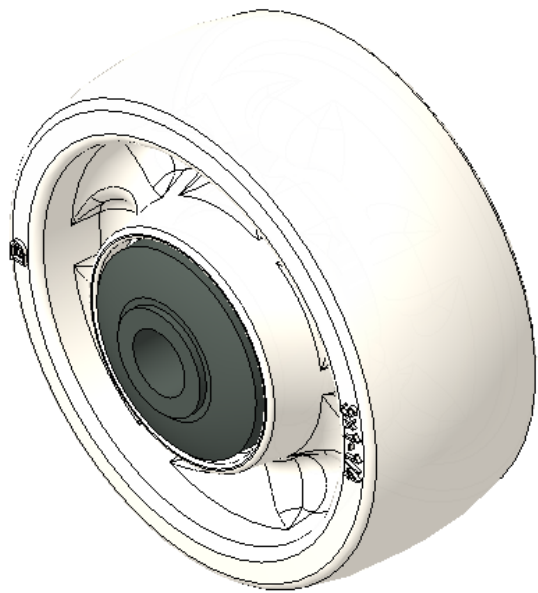

Picture may differ from original product

Technical Data

<input checked="" type="radio"/> Imperial <input type="radio"/> Metric	
Wheel Diameter(D)	3 "
Wheel Width(T2)	1-1/4 "
Wheel Bearing	Ball Bearing
Axle Bore(d)	3/8 "
Axle Bore(S)	—
Bearing Bore Depth(t)	—
Hub Lenth(T1)	1-5/8 "
Hardness Of Tread	75±5° Shore D
Load Capacity (Dynamic)	265lbs
Load Capacity (Static)	397lbs
Temperature	-4°F to +176°F
Electrical Conductivity	N/A
Anti-Static	N/A
Weight	0.4lbs
Standard	ISO22883

Advantages at a glance

Rolling Resistance	● ● ● ● ●
Operating Noise	● ● ○ ○ ○
Floor Surface Preservation	● ● ○ ○ ○

2D Dimensional Drawing of Single Wheel

* For any deviation between metric and imperial spec, please refer to the metric spec.