



WMRC Series

WMRC (Transparent) Wheel Diameter × Wheel Width 100 x 31mm

EAN

KS-1202070413W173

Impact Resistance, Non-Marking, Not Be Dyed, Corrosion resistant, very Great Abrasion Resistance, Odorless Resistant to many chemicals, Heavy Load, very low Rolling Resistance Color: Natural, with Dust Cap

Wheel Tread: Thermoplastic (PA6)  
Wheel Center: Thermoplastic (PA6)  
Bearing: precision ball

Drawings are for reference only and may differ from the product

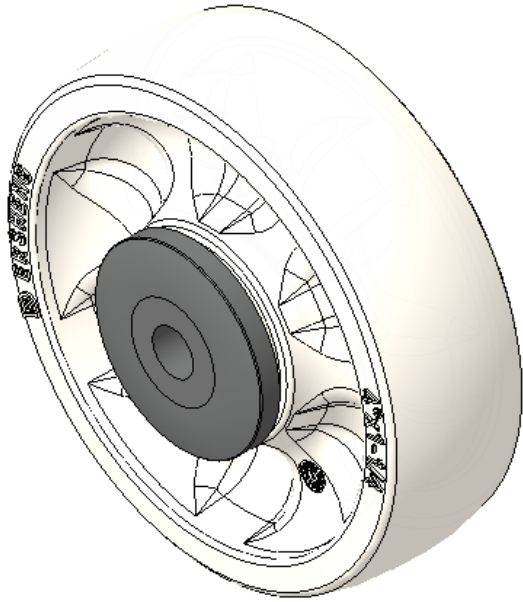

Picture may differ from original product

Technical Data

<input checked="" type="radio"/> Metric <input type="radio"/> Imperial	
Wheel Diameter(D)	100mm
Wheel Width(T2)	31mm
Wheel Bearing	Ball Bearing
Axle Bore(d)	10mm
Axle Bore(S)	—
Bearing Bore Depth(t)	—
Hub Lenth(T1)	42mm
Hardness Of Tread	75±5° Shore D
Load Capacity (Dynamic)	160kgs
Load Capacity (Static)	240kgs
Temperature	-20°C to +80°C
Electrical Conductivity	N/A
Anti-Static	N/A
Weight	0.20kgs
Standard	ISO22883

Advantages at a glance

Rolling Resistance	● ● ● ● ●
Operating Noise	● ● ○ ○ ○
Floor Surface Preservation	● ● ○ ○ ○

2D Dimensional Drawing of Single Wheel

\* For any deviation between metric and imperial spec, please refer to the metric spec.