



PP Series

PP Wheel (Black-Black) Wheel Diameter × Wheel Width 50 × 45mm

D  
KS-12022902181373

Good Heat Resistance, Rigid yet tough, fatigue-resistant, and stress-cracking resistant. Unaffected by humidity, resistant to corrosion, oil, acids, alkalis, and other solven. Odorless and recyclable, with Heavy Load and low Rolling Resistance.  
Color: Black

Wheel Center: High-quality impact-resistant polypropylene  
Wheel Tread: High-quality impact-resistant polypropylene  
Bearing: Ball bearing

Drawings are for reference only and may differ from the product



Picture may differ from original product

Technical Data

<input checked="" type="radio"/> Metric <input type="radio"/> Imperial	
Wheel Diameter(D)	50mm
Wheel Width(T2)	45mm
Wheel Bearing	Ball Bearing
Axle Bore(d)	10mm
Axle Bore(S)	—
Bearing Bore Depth(t)	—
Hub Lenth(T1)	50mm
Hardness Of Tread	65±5° Shore D
Load Capacity (Dynamic)	50kgs
Load Capacity (Static)	75kgs
Temperature	-10°C to +60°C
Electrical Conductivity	N/A
Anti-Static	N/A
Weight	0.02kgs
Standard	ISO22883

Advantages at a glance

Rolling Resistance	● ● ● ● ●
Operating Noise	● ● ● ○ ○
Floor Surface Preservation	● ● ● ○ ○

2D Dimensional Drawing of Single Wheel

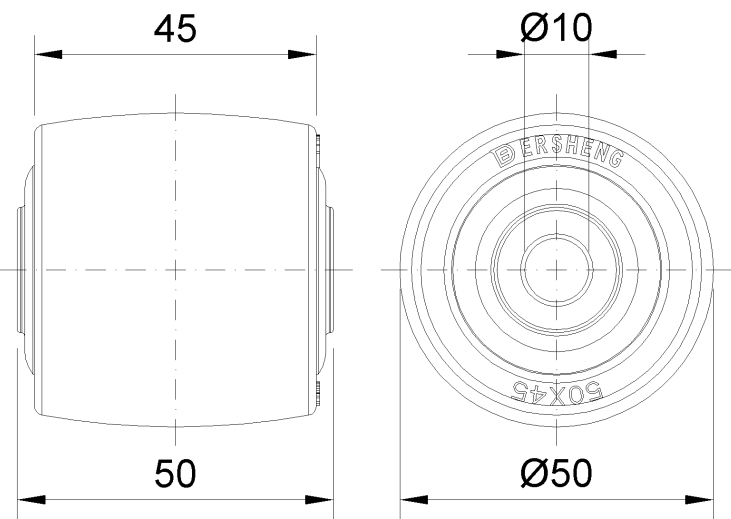

\* For any deviation between metric and imperial spec, please refer to the metric spec.