



Blue Resilient Resolute Rubber Wheel Series

Full-Effect Elastic Wheel (Black & Blue) Wheel Diameter × Wheel Width 200×48mm

EAN

KS-12024508191173

Easy to Floor Surface Preservation, Non-Markings, Easy To Maneuver, and can withstand heavy loads.
Low rolling and Swivel Resistance, resistant to corrosion from many corrosive substances.
Color: Black/Blue, includes bearing + tube + gasket.

Wheel core: Made of high-quality impact-resistant polypropylene
Wheel tread: Thermoplastic rubber elastomer (TPR)
Bearing: Precision ball bearing

Drawings are for reference only and may differ from the product

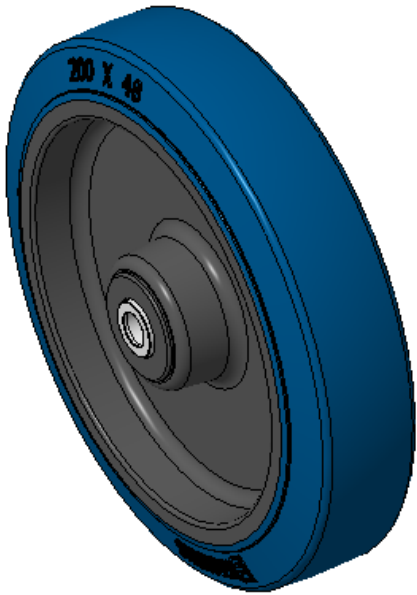

Picture may differ from original product

Technical Data

| | |
|--|----------------------|
| <input checked="" type="radio"/> Metric <input type="radio"/> Imperial | |
| Wheel Diameter(D) | 200mm |
| Wheel Width(T2) | 48mm |
| Wheel Bearing | Annular Ball Bearing |
| Axle Bore(d) | 12.2mm |
| Axle Bore(S) | — |
| Bearing Bore Depth(t) | — |
| Hub Lenth(T1) | 55mm |
| Hardness Of Tread | 72±5° Shore A |
| Load Capacity (Dynamic) | 325kgs |
| Load Capacity (Static) | 487.5kgs |
| Temperature | -20°C to +60°C |
| Electrical Conductivity | N/A |
| Anti-Static | N/A |
| Weight | 1.01kgs |
| Standard | ISO22883 |

Advantages at a glance

| | |
|----------------------------|-----------|
| Rolling Resistance | ● ● ● ● ● |
| Operating Noise | ● ● ● ● ● |
| Floor Surface Preservation | ● ● ● ● ● |

2D Dimensional Drawing of Single Wheel

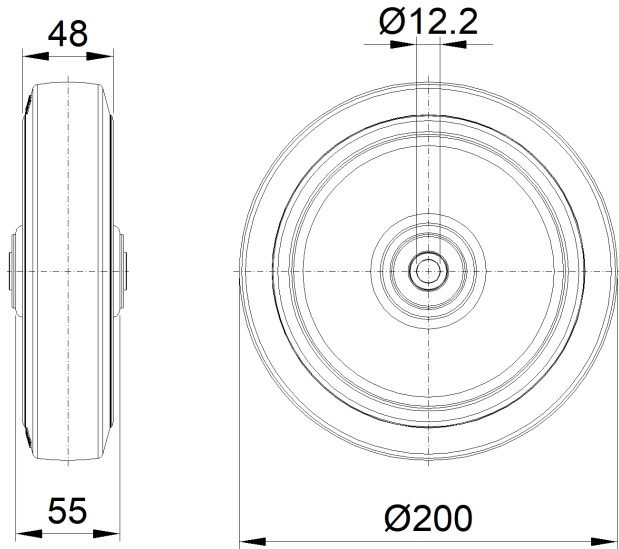

* For any deviation between metric and imperial spec, please refer to the metric spec.