



Rubber Wheel Series

Wheel Diameter ×WheelWidth 200 × 48mm

EAN  
TW-412480800013

It offers excellent operating comfort, superior Floor Surface Preservation, and Shock-Absorbing.  
Black Plastic Wheel Center with needle bearings and an Iron Plain Bearing.

Wheel Tread: High-quality impact-resistant polypropylene  
Outer material: high quality elastic rubber  
Bearing: needle roller bearing

Drawings are for reference only and may differ from the product

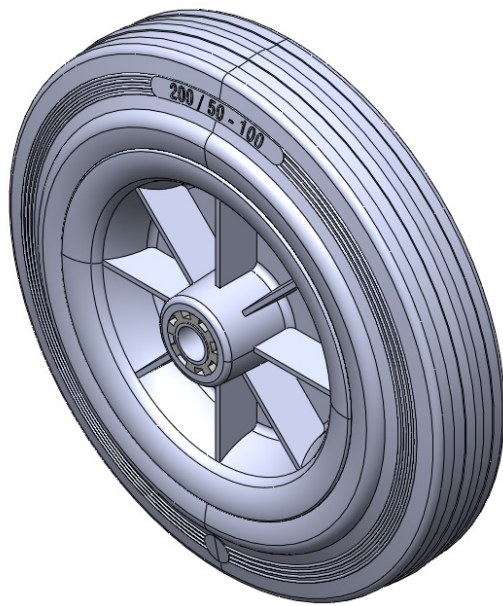

Picture may differ from original product

Technical Data

|  |                        |
|--|------------------------|
| <input checked="" type="radio"/> Metric <input type="radio"/> Imperial |                        |
| Wheel Diameter(D)  | 200mm                  |
| Wheel Width(T2)  | 48mm                   |
|  |                        |
| Wheel Bearing  | Tapered roller bearing |
| Axle Bore(d)   | 12.4mm                 |
| Axle Bore(S)   | mm                     |
| Bearing Bore Depth(t)  |                        |
| Hub Lenth(T1)  | 60mm                   |
| Hardness Of Tread  | 80±5° Shore A          |
| Load Capacity (Dynamic)  | 205kgs                 |
| Load Capacity (Static)   | 307.5kgs               |
| Temperature  | -20°C to +120°C        |
| Electrical Conductivity  | N/A                    |
| Anti-Static  | N/A                    |
| Weight   | 1.116kgs               |
| Standard   | ISO22883               |

Advantages at a glance

|                            |           |
|----------------------------|-----------|
| Rolling Resistance         | ● ● ● ○ ○ |
| Operating Noise            | ● ● ● ● ○ |
| Floor Surface Preservation | ● ● ● ● ○ |

2D Dimensional Drawing of Single Wheel

\* For any deviation between metric and imperial spec, please refer to the metric spec.