



AQPU Series

Wheel Diameter × Wheel Width 125 x 40mm

EAN
TW-412920500019
YJ-12036005155471

It has good elasticity, reduces pushing resistance, improves machine controllability, and has good wear resistance.
It has excellent Hydrolysis Resistance.
Suitable for tropical regions and humid working environments.
QPU Blue, Curved Wheel Surface

Wheel Center: Aluminum core
Wheel Tread: High-quality polyurethane
Bearing: Ball bearing

Drawings are for reference only and may differ from the product

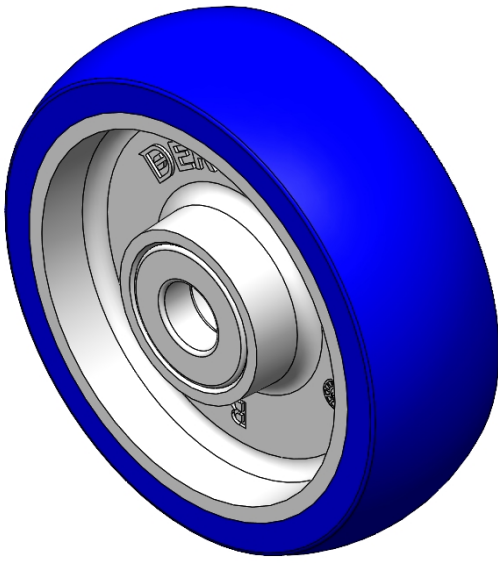

Picture may differ from original product

Technical Data

<input checked="" type="radio"/> Imperial <input type="radio"/> Metric	
Wheel Diameter(D)	5 "
Wheel Width(T2)	1-5/8 "
Wheel Bearing	Ball Bearing
Axle Bore(d)	11/16 "
Axle Bore(S)	—
Bearing Bore Depth(t)	—
Hub Lenth(T1)	1-5/8 "
Hardness Of Tread	87±5° Shore A
Load Capacity (Dynamic)	772lbs
Load Capacity (Static)	1157lbs
Temperature	-4°F to +158°F
Electrical Conductivity	Y
Anti-Static	Y
Weight	1.3lbs
Standard	ISO22883

Advantages at a glance

Rolling Resistance	● ● ● ● ●
Operating Noise	● ● ● ● ●
Floor Surface Preservation	● ● ● ● ●

2D Dimensional Drawing of Single Wheel

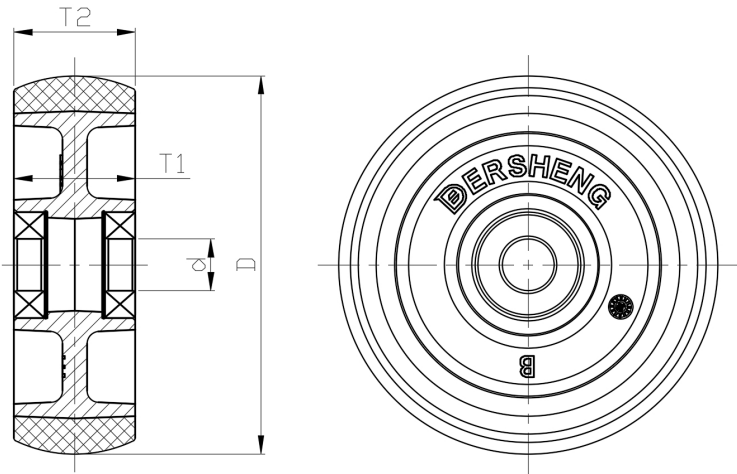

* For any deviation between metric and imperial spec, please refer to the metric spec.