



1168 Levelling Caster Series

AQPU (brown round) Wheel Diameter × Wheel Width 100 x 40mm

EAN

YJ-11680400602013

Height Adjustable Leveling Caster, Top Plate Riveted and Stamping with European standard holes, Long Pedal Zine-Plated, Mounting Type - Top Plate, Height Adjustable Stand Aluminum Wheel Center, High Quality Polyurethane tread Brown, Bearing—Ball Bearing.

Wheel Tread: high quality polyurethane
Wheel Center: aluminum core

Drawings are for reference only and may differ from the product

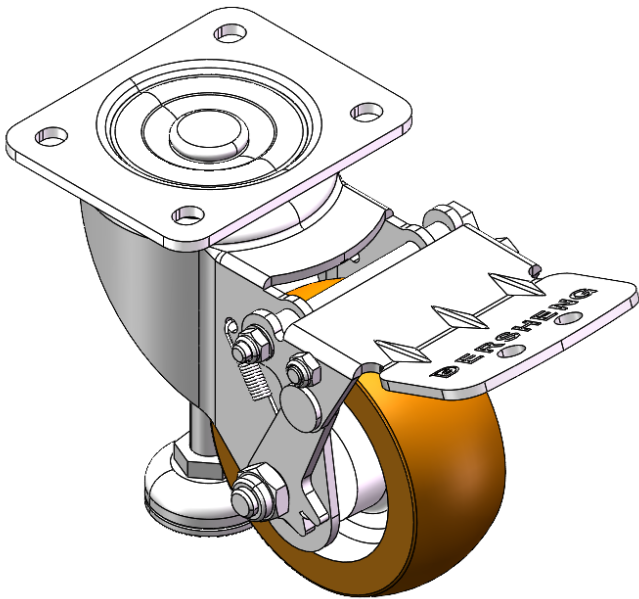

Picture may differ from original product

Technical Data

<input checked="" type="radio"/> Imperial <input type="radio"/> Metric	
Wheel Diameter	4 "
Wheel Width	1-5/8 "
Wheel Bearing	Wheels With Ball Bearings
Plate Size	4-3/16 " x 3-7/16 "
Bolt Hole Spacing	3-3/16 " x 2-7/16 "
Plate Hole	3/8 " x 23/64 "
Offset	2-9/16 "
Swivel Interference	12 "
Overall Height	5-11/16 "
Swivel Radius	6 "
Hardness Of Tread	92±5° Shore A
Load Capacity (Dynamic)	705lbs
Load Capacity (Static)	2205lbs
Temperature	-4°F to +158°F
Fork Type	Swivel Caster
Stainless	N/A
Electrical Conductivity	N/A
Anti-Static	N/A
Weight	4.9lbs
Standard	ISO22883

Advantages at a glance

Rolling Resistance	● ● ● ● ●
Operating Noise	● ● ● ● ●
Floor Surface Preservation	● ● ● ● ●

Dimensions

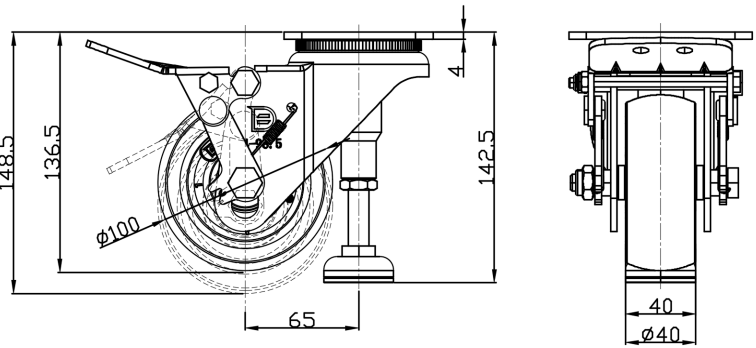

Mounting

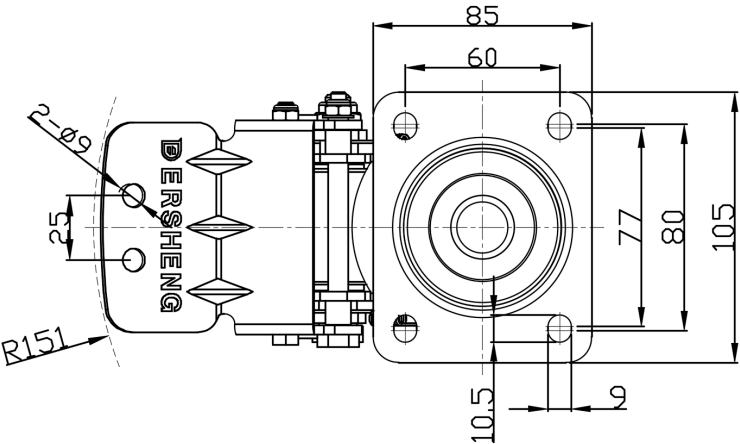

* For any deviation between metric and imperial spec, please refer to the metric spec.