

RX-PU Series



Wheel Diameter × Wheel Width 80 x 60mm

EAN

YJ-12033303236171

Provides excellent Floor Surface Preservation and wear resistance, with Low Noise Operation.
Has excellent Hydrolysis Resistance.
Suitable for tropical regions and humid working environments.
PU Red

Wheel Tread: cast iron core
Wheel Center: High-quality polyurethane
Bearing: ball bearing

Drawings are for reference only and may differ from the product

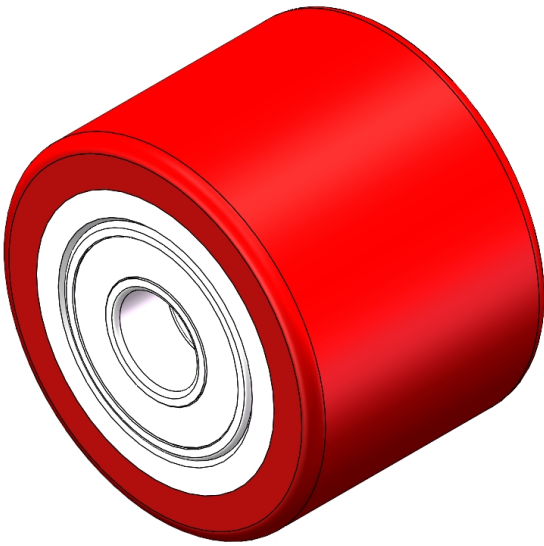

Picture may differ from original product

Technical Data

<input checked="" type="radio"/> Imperial <input type="radio"/> Metric	
Wheel Diameter(D)	3-3/16 "
Wheel Width(T2)	2-7/16 "
Wheel Bearing	Ball Bearing
Axle Bore(d)	13/16 "
Axle Bore(S)	
Bearing Bore Depth(t)	
Hardness Of Tread	92±5° Shore A
Load Capacity (Dynamic)	1102lbs
Load Capacity (Static)	1653lbs
Temperature	-4°F to +158°F
Electrical Conductivity	N/A
Anti-Static	N/A
Weight	2.1lbs
Standard	ISO22883

Advantages at a glance

Rolling Resistance	● ● ● ○ ○
Operating Noise	● ● ● ● ○
Floor Surface Preservation	● ● ● ● ● ○

2D Dimensional Drawing of Single Wheel

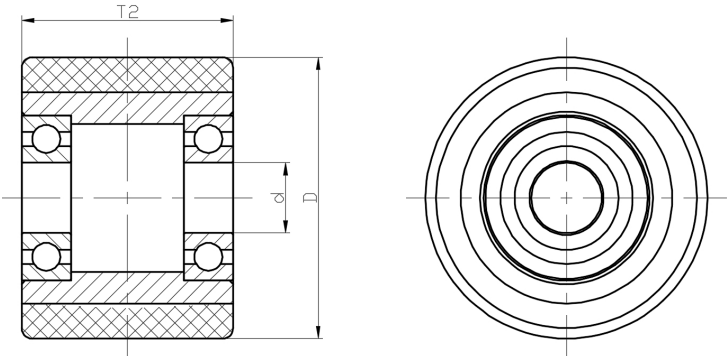

* For any deviation between metric and imperial spec, please refer to the metric spec.