



PU Series

Wheel Diameter × Wheel Width 125 x 45mm

EAN

YJ-12033305180100

Excellent Floor Surface Preservation and wear resistance, low noise.
Excellent Hydrolysis Resistance.
Suitable for tropical regions and humid working environments.
PU Red

Wheel Center: Iron core
Wheel Tread: High-quality polyurethane

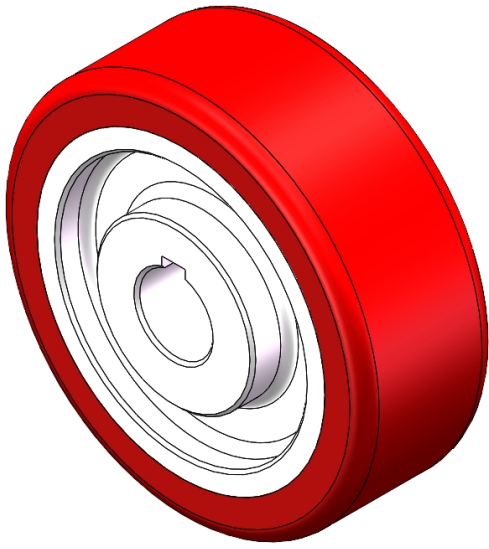

Picture may differ from original product

Product descriptions are for reference only. The actual product shall prevail.

Technical Data

| | |
|--|--|
| <input checked="" type="radio"/> Metric <input type="radio"/> Imperial | |
| Wheel Diameter (D) | 125mm |
| Wheel Width (T2) | 45mm |
| Wheel installation — Hub Lenth (T1) | 50mm |
| Wheel Mounting Bore Diameter | 25mm |
| Keyway Width | 8mm |
| Wheel Keyway Depth (H) | 28.3mm |
| Load Capacity (Static) | 525kgs |
| Load Capacity at 4 km/h | 350kgs |
| Load Capacity at 6 km/h | 297.5kgs |
| Load Capacity at 10 km/h | 245kgs |
| Load Capacity at 16 km/h | 140kgs |
| Hardness Of Tread | 92±5° Shore A |
| Temperature | -20°C to +70°C |
| Tread Pattern | — |
| Wheel centre/ rim | Cast iron / spray-baked black paint |
| Non-Marking | Y |
| Conductive | N/A |
| Anti | N/A |
| Weight | 2.39kgs |
| Standard | ISO22883 |

Advantages at a glance

| | |
|----------------------------|-------------|
| Rolling Resistance | ● ● ● ● ● |
| Operating Noise | ● ● ● ● ● |
| Floor Surface Preservation | ● ● ● ● ● ○ |

2D Dimensional Drawing of Drive Wheel

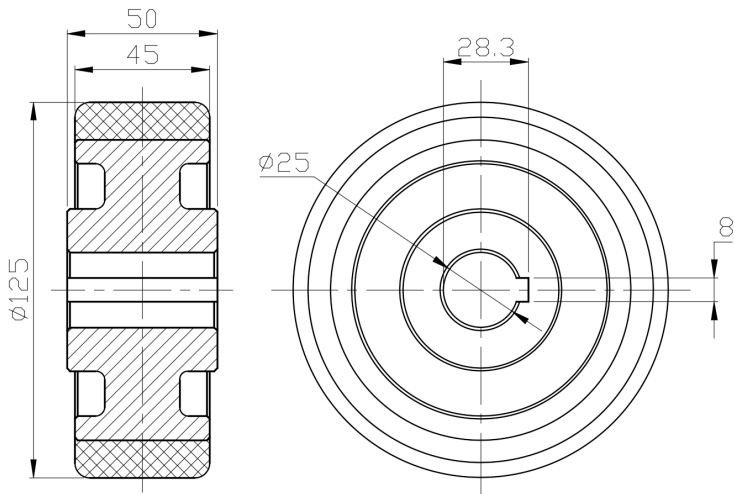

* For any deviation between metric and imperial spec, please refer to the metric spec.