

PU Series

Wheel Diameter × Wheel Width 125 x 45mm

EAN

YJ-12033305180100

Excellent Floor Surface Preservation and wear resistance, low noise.  
Excellent Hydrolysis Resistance.  
Suitable for tropical regions and humid working environments.  
PU Red

Wheel Center: Iron core  
Wheel Tread: High-quality polyurethane

Product descriptions are for reference only. The actual product shall prevail.

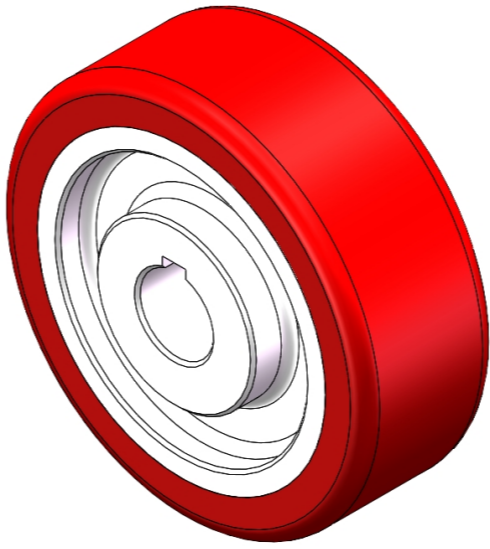

Picture may differ from original product

Technical Data

<input checked="" type="radio"/> Imperial <input type="radio"/> Metric	
Wheel Diameter (D)	5 "
Wheel Width (T2)	1-13/16 "
Wheel installation — Hub Lenth (T1)	2 "
Wheel Mounting Bore Diameter	1 "
Keyway Width	3/8 "
Wheel Keyway Depth (H)	28.3
Load Capacity (Static)	1157lbs
Load Capacity at 4 km/h	772lbs
Load Capacity at 6 km/h	656lbs
Load Capacity at 10 km/h	540lbs
Load Capacity at 16 km/h	309lbs
Hardness Of Tread	92±5° Shore A
Temperature	-4°F to +158°F
Tread Pattern	—
Wheel centre/ rim	Cast iron / spray-baked black paint
Non-Marking	Y
Conductive	N/A
Anti	N/A
Weight	5.3lbs
Standard	ISO22883

Advantages at a glance

Rolling Resistance	● ● ● ● ●
Operating Noise	● ● ● ● ●
Floor Surface Preservation	● ● ● ● ● ○

2D Dimensional Drawing of Drive Wheel

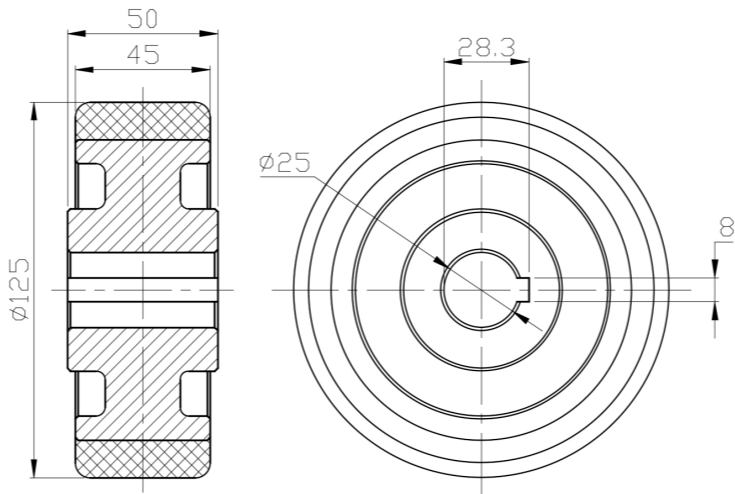

\* For any deviation between metric and imperial spec, please refer to the metric spec.