

QPU Series



Wheel Diameter × Wheel Width 100 x 34mm

EAN

YJ-12035304139101

Excellent elasticity, reduced push resistance, improved machine controllability, and Excellent Wear Resistant.
Excellent Hydrolysis Resistance.
Suitable for tropical and humid working environments.
QPU brown, Wheel Tread profile: Crown

Wheel Tread: cast iron core
Wheel Center: High-quality polyurethane
Bearing: —

Drawings are for reference only and may differ from the product

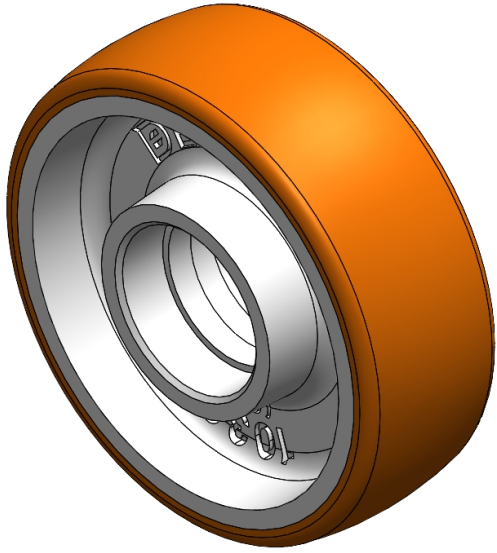

Picture may differ from original product

Technical Data

<input checked="" type="radio"/> Metric <input type="radio"/> Imperial	
Wheel Diameter(D)	100mm
Wheel Width(T2)	34mm
Wheel Bearing	Without Bearing
Axle Bore(d)	
Axle Bore(S)	35mm
Bearing Bore Depth(t)	11mm
Hub Lenth(T1)	34mm
Hardness Of Tread	92±5° Shore A
Load Capacity (Dynamic)	320kgs
Load Capacity (Static)	480kgs
Temperature	-20°C to +70°C
Electrical Conductivity	N/A
Anti-Static	N/A
Weight	0.63kgs
Standard	ISO22883

Advantages at a glance

Rolling Resistance	● ● ● ● ●
Operating Noise	● ● ● ● ●
Floor Surface Preservation	● ● ● ● ●

2D Dimensional Drawing of Single Wheel

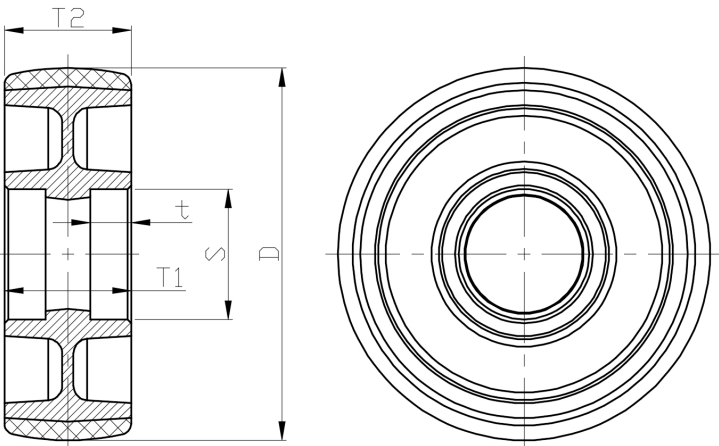

* For any deviation between metric and imperial spec, please refer to the metric spec.