

QPU Series



Wheel Diameter × Wheel Width 100 x 34mm

EAN

YJ-12035304139101

Excellent elasticity, reduced push resistance, improved machine controllability, and Excellent Wear Resistant.
Excellent Hydrolysis Resistance.
Suitable for tropical and humid working environments.
QPU brown, Wheel Tread profile: Crown

Wheel Tread: cast iron core
Wheel Center: High-quality polyurethane
Bearing: —

Drawings are for reference only and may differ from the product

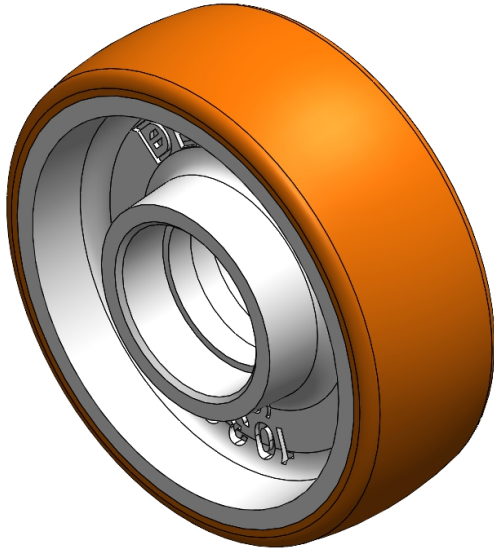

Picture may differ from original product

Technical Data

<input checked="" type="radio"/> Imperial <input type="radio"/> Metric	
Wheel Diameter(D)	4 "
Wheel Width(T2)	1-3/8 "
Wheel Bearing	Without Bearing
Axle Bore(d)	
Axle Bore(S)	1-3/8 "
Bearing Bore Depth(t)	3/8 "
Hub Lenth(T1)	34
Hardness Of Tread	92±5° Shore A
Load Capacity (Dynamic)	705lbs
Load Capacity (Static)	1058lbs
Temperature	-4°F to +158°F
Electrical Conductivity	N/A
Anti-Static	N/A
Weight	1.4lbs
Standard	ISO22883

Advantages at a glance

Rolling Resistance	• • • • •
Operating Noise	• • • • •
Floor Surface Preservation	• • • • •

2D Dimensional Drawing of Single Wheel

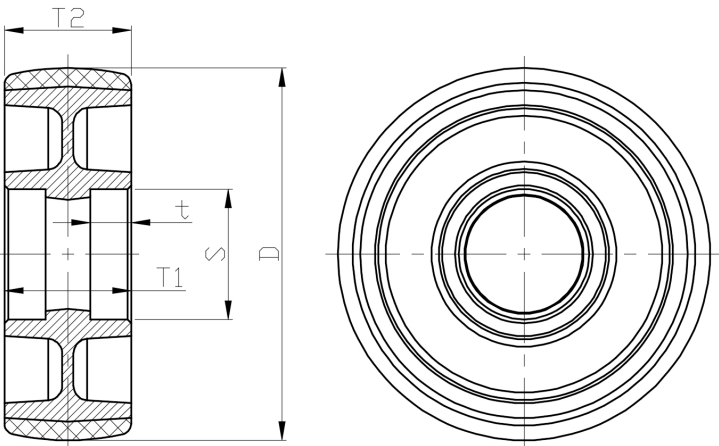

* For any deviation between metric and imperial spec, please refer to the metric spec.