

QPU Series



Wheel Diameter × Wheel Width 114 x 25mm

EAN

YJ-12035354106101

Good elasticity, reduces pushing resistance, improves machine controllability, and has good wear resistance.  
Excellent Hydrolysis Resistance.  
Suitable for tropical regions and humid working environments.  
QPU, brown, with machined straight grain.  
Increases grip on the ground and effectively improves anti-slip ability.

Wheel Center: cast iron core  
Wheel Tread: High-quality polyurethane  
Bearings: —

Drawings are for reference only and may differ from the product

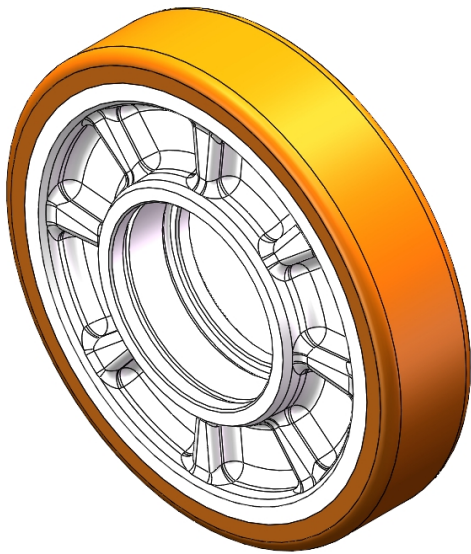

Picture may differ from original product

Technical Data

<input checked="" type="radio"/> Imperial <input type="radio"/> Metric	
Wheel Diameter(D)	4-1/2 "
Wheel Width(T2)	5-1/25 "
Wheel Bearing	Without Bearing
Axle Bore(d)	—
Axle Bore(S)	3/8 "
Bearing Bore Depth(t)	11/16 "
Hub Lenth(T1)	3/4 "
Hardness Of Tread	92±5° Shore A
Load Capacity (Dynamic)	331lbs
Load Capacity (Static)	496lbs
Temperature	-4°F to +158°F
Electrical Conductivity	N/A
Anti-Static	N/A
Weight	1.5lbs
Standard	ISO22883

Advantages at a glance

Rolling Resistance	● ● ● ● ●
Operating Noise	● ● ● ● ●
Floor Surface Preservation	● ● ● ● ●

2D Dimensional Drawing of Single Wheel

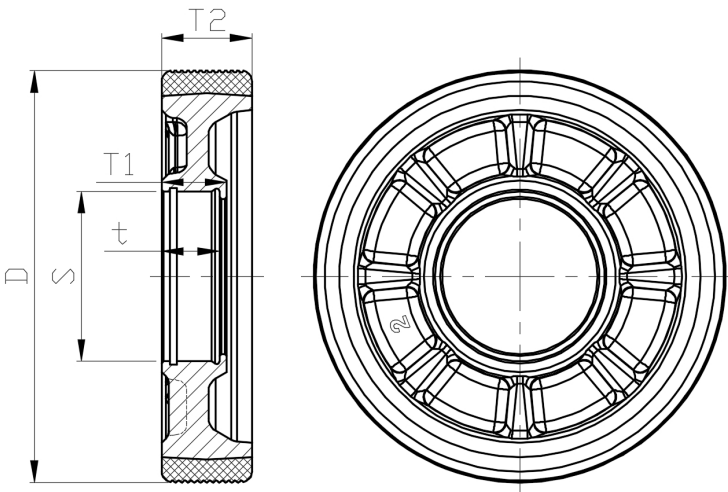

\* For any deviation between metric and imperial spec, please refer to the metric spec.