

QPU Series



Wheel Diameter × Wheel Width 250 x 62mm

EAN

YJ-12035410256201

Good elasticity, reduces pushing resistance, improves machine controllability, and has good wear resistance.  
Excellent Hydrolysis Resistance.  
Suitable for tropical regions and humid working environments.  
QPU Blue, Curved Wheel Surface

Wheel Tread: cast iron core  
Wheel Center: High-quality polyurethane  
Bearings: —

Drawings are for reference only and may differ from the product

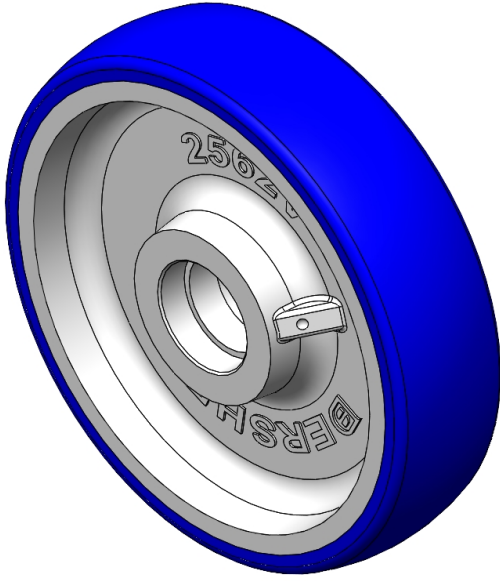

Picture may differ from original product

Technical Data

<input checked="" type="radio"/> Metric <input type="radio"/> Imperial	
Wheel Diameter(D)	250mm
Wheel Width(T2)	62mm
Wheel Bearing	Without Bearing
Axle Bore(d)	
Axle Bore(S)	52mm
Bearing Bore Depth(t)	15mm
Hub Lenth(T1)	61mm
Hardness Of Tread	87±5° Shore A
Load Capacity (Dynamic)	926kgs
Load Capacity (Static)	1389kgs
Temperature	-20°C to +70°C
Electrical Conductivity	N/A
Anti-Static	N/A
Weight	7.82kgs
Standard	ISO22883

Advantages at a glance

Rolling Resistance	● ● ● ● ●
Operating Noise	● ● ● ● ●
Floor Surface Preservation	● ● ● ● ●

2D Dimensional Drawing of Single Wheel

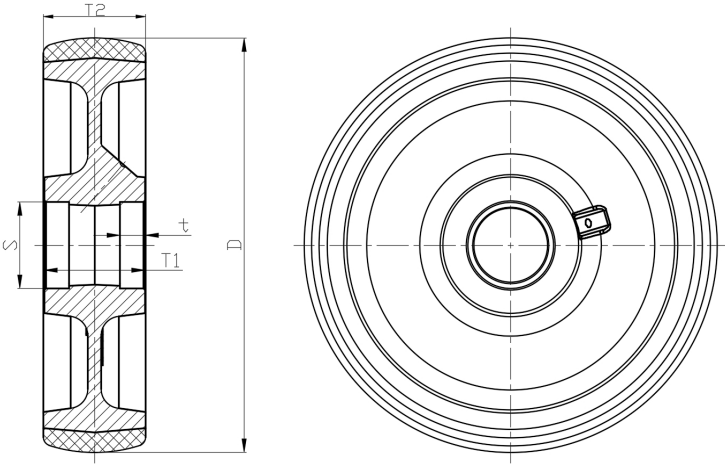

\* For any deviation between metric and imperial spec, please refer to the metric spec.