

XPU Series



Wheel Diameter × Wheel Width 125 x 45mm

EAN

YJ-12036105180103

Excellent Mechanical Properties, maintaining Heavy Load during high-speed movement; good wear resistance; not easily deformed.
Excellent resistance to chemicals, solvents, and corrosion.
Suitable for Forklift Trucks, Electric Stackers, Heavy duty machines, AGVs, and automated industrial applications.
XPU Burgundy

Wheel Center: Iron core
Wheel Tread: High-quality polyurethane

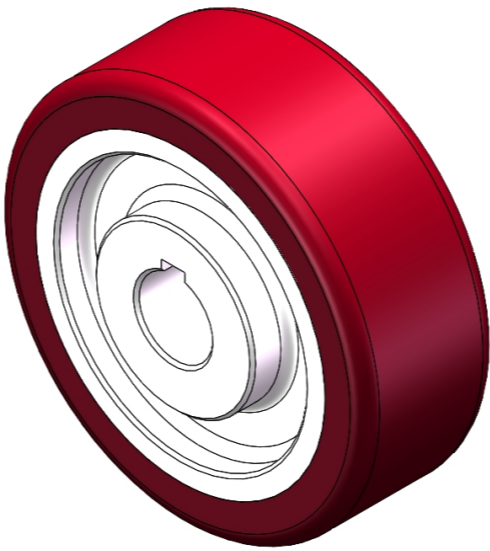

Picture may differ from original product

Product descriptions are for reference only. The actual product shall prevail.

Technical Data

| | |
|--|--|
| <input checked="" type="radio"/> Imperial <input type="radio"/> Metric | |
| Wheel Diameter (D) | 5 " |
| Wheel Width (T2) | 1-13/16 " |
| Wheel installation — Hub Lenth (T1) | 2 " |
| Wheel Mounting Bore Diameter | 1 " |
| Keyway Width | 3/8 " |
| Wheel Keyway Depth (H) | 28.3 |
| Load Capacity (Static) | 1653lbs |
| Load Capacity at 4 km/h | 1102lbs |
| Load Capacity at 6 km/h | 937lbs |
| Load Capacity at 10 km/h | 772lbs |
| Load Capacity at 16 km/h | 441lbs |
| Hardness Of Tread | 92±5° Shore A |
| Temperature | -4°F to +158°F |
| Tread Pattern | — |
| Wheel centre/ rim | Cast iron / spray-baked black paint |
| Non-Marking | Y |
| Conductive | N/A |
| Anti | N/A |
| Weight | 5.3lbs |
| Standard | ISO22883 |

Advantages at a glance

| | |
|----------------------------|-------------|
| Rolling Resistance | ● ● ● ● ● |
| Operating Noise | ● ● ● ● ● |
| Floor Surface Preservation | ● ● ● ● ● ○ |

2D Dimensional Drawing of Drive Wheel

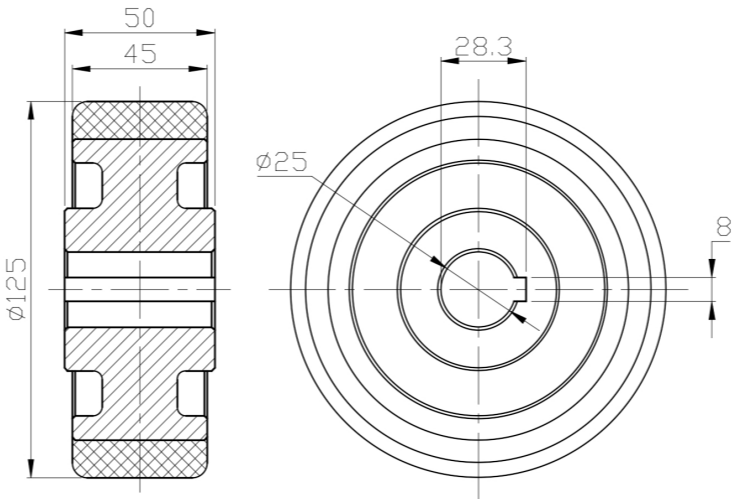

* For any deviation between metric and imperial spec, please refer to the metric spec.