

QPU Series

Wheel Diameter × Wheel Width 127 x 42mm

EAN

YJ-12036305180103

Good elasticity, reduces pushing resistance, improves machine controllability, and has good wear resistance.
 Excellent Hydrolysis Resistance.
 Suitable for tropical regions and humid working environments.
 QPU, black, surface machined with random texture.
 Increases grip on the ground, effectively improving anti-slip ability.

Wheel Center: Iron core

Wheel Tread: High-quality polyurethane



Picture may differ from original product

Product descriptions are for reference only. The actual product shall prevail.

Technical Data

Metric Imperial

Wheel Diameter (D)	127mm
Wheel Width (T2)	42mm
Wheel installation — Hub Lenth (T1)	41mm
Wheel center-bore diameter (d)	96.6mm
Wheel Mounting Bolt Hole PCD Diameter	—
Wheel Mounting Bolt Hole PCD	103.5mm
# Of Wheel mounting bolt boles	—
Wheel mounting bolt hole (M)	4
Number of wheel mounting bolt holes	6
Load Capacity (Static)	120kgs
Load Capacity at 4 km/h	80kgs
Load Capacity at 6 km/h	68kgs
Load Capacity at 10 km/h	56kgs
Load Capacity at 16 km/h	32kgs
Hardness Of Tread	77±5° Shore A
Temperature	-20°C to +70°C
Tread Pattern	garbled text pattern
Wheel centre/ rim	Iron core/galvanized
Non-Marking	Y
Conductive	N/A 10 ⁶ ~10 ⁹ Ω
Anti	N/A
Weight	0.88kgs
Standard	ISO22883

Advantages at a glance

Rolling Resistance	●●●●●
Operating Noise	●●●●●
Floor Surface Preservation	●●●●●

2D Dimensional Drawing of Drive Wheel

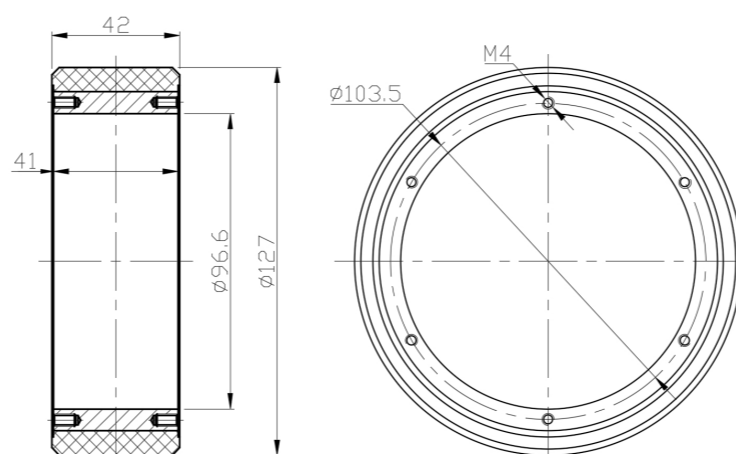

* For any deviation between metric and imperial spec, please refer to the metric spec.