

QPU Series

Wheel Diameter × Wheel Width 127 x 42mm

EAN

YJ-12036305180103

Good elasticity, reduces pushing resistance, improves machine controllability, and has good wear resistance.

Excellent Hydrolysis Resistance.

Suitable for tropical regions and humid working environments.

QPU, black, surface machined with random texture.

Increases grip on the ground, effectively improving anti-slip ability.

Wheel Center: Iron core

Wheel Tread: High-quality polyurethane



Picture may differ from original product

Product descriptions are for reference only. The actual product shall prevail.

Technical Data

Imperial Metric

| | |
|---------------------------------------|--|
| Wheel Diameter (D) | 5-1/16 " |
| Wheel Width (T2) | 1-11/16 " |
| Wheel installation — Hub Lenth (T1) | 1-5/8 " |
| Wheel center-bore diameter (d) | 3-7/8 " |
| Wheel Mounting Bolt Hole PCD Diameter | — |
| Wheel Mounting Bolt Hole PCD | 2-1/2 " |
| # Of Wheel mounting bolt boles | — |
| Wheel mounting bolt hole (M) | 4 |
| Number of wheel mounting bolt holes | 6 |
| Load Capacity (Static) | 265lbs |
| Load Capacity at 4 km/h | 176lbs |
| Load Capacity at 6 km/h | 150lbs |
| Load Capacity at 10 km/h | 123lbs |
| Load Capacity at 16 km/h | 71lbs |
| Hardness Of Tread | 77±5° Shore A |
| Temperature | -4°F to +158°F |
| Tread Pattern | garbled text pattern |
| Wheel centre/ rim | Iron core/galvanized |
| Non-Marking | Y |
| Conductive | N/A 10 ⁶ ~10 ⁹ Ω |
| Anti | N/A |
| Weight | 1.9lbs |
| Standard | ISO22883 |

Advantages at a glance

| | |
|----------------------------|-------|
| Rolling Resistance | ●●●●● |
| Operating Noise | ●●●●● |
| Floor Surface Preservation | ●●●●● |

2D Dimensional Drawing of Drive Wheel

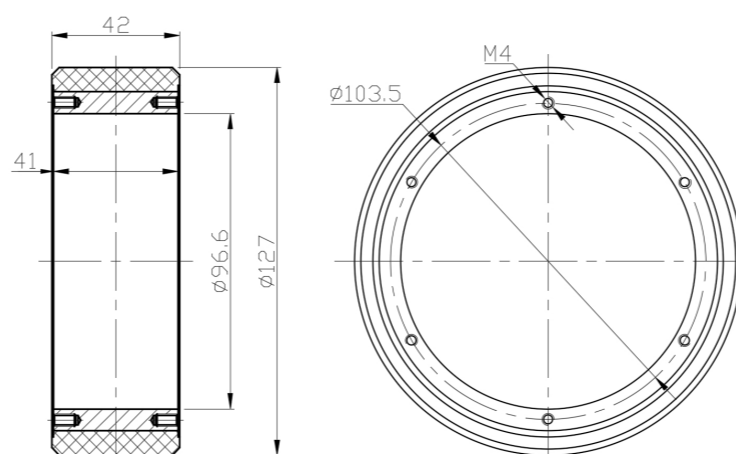

* For any deviation between metric and imperial spec, please refer to the metric spec.