

QPU Series



Wheel Diameter × Wheel Width 150 x 40mm

EAN

YJ-12036306180101

It has good elasticity, reduces pushing resistance, and improves machine controllability; good wear resistance.
It has excellent Hydrolysis Resistance.
Suitable for tropical regions and humid working environments.
QPU gray surface with machined straight and V-patterns.
Increases grip on the ground and effectively improves anti-slip ability.

Wheel Center: cast iron
Wheel Tread: High-quality polyurethane



Picture may differ from original product

Product descriptions are for reference only. The actual product shall prevail.

Technical Data

<input checked="" type="radio"/> Imperial <input type="radio"/> Metric	
Wheel Diameter (D)	6 "
Wheel Width (T2)	1-5/8 "
Wheel installation — Hub Lenth (T1)	3/8 "
Wheel center-bore diameter (d)	2 "
Wheel Mounting Bolt Hole PCD Diameter	1/4 "
Wheel Mounting Bolt Hole PCD	2-13/16 "
# Of Wheel mounting bolt boles	1/4 "
Wheel mounting bolt hole (M)	—
Number of wheel mounting bolt holes	—
Load Capacity (Static)	1389lbs
Load Capacity at 4 km/h	926lbs
Load Capacity at 6 km/h	787lbs
Load Capacity at 10 km/h	370lbs
Load Capacity at 16 km/h	370lbs
Hardness Of Tread	77±5° Shore A
Temperature	-4°F to +158°F
Tread Pattern	Straight lines + V-lines
Wheel centre/ rim	Iron core/galvanized
Non-Marking	N/A
Conductive	N/A
Anti	N/A
Weight	2.9lbs
Standard	ISO22883

Advantages at a glance

Rolling Resistance	● ● ● ● ●
Operating Noise	● ● ● ● ●
Floor Surface Preservation	● ● ● ● ●

2D Dimensional Drawing of Drive Wheel

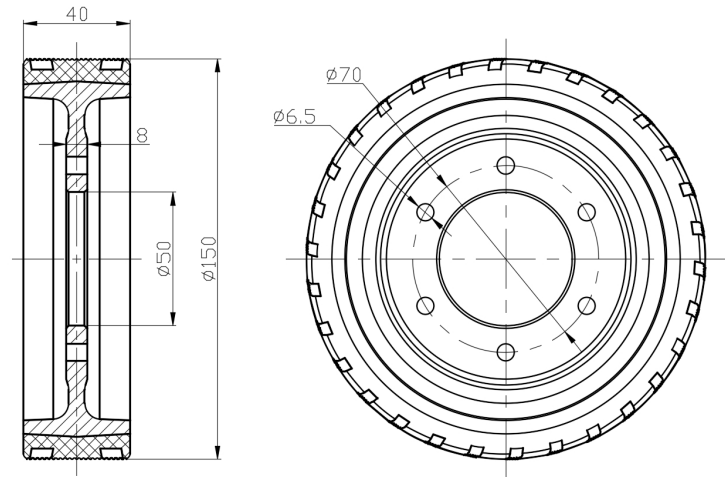

* For any deviation between metric and imperial spec, please refer to the metric spec.