



QPU Series

Wheel Diameter × Wheel Width 185 x 60mm

EAN

YJ-12036357230103

It has good elasticity, reduces pushing resistance, improves machine tool operability, and has good wear resistance.
It has excellent Hydrolysis Resistance.
Suitable for tropical regions and humid working environments.
QPU, brown, Wheel Tread profile: Crown

Wheel Center: Iron core
Wheel Tread: High-quality polyurethane

Product descriptions are for reference only. The actual product shall prevail.

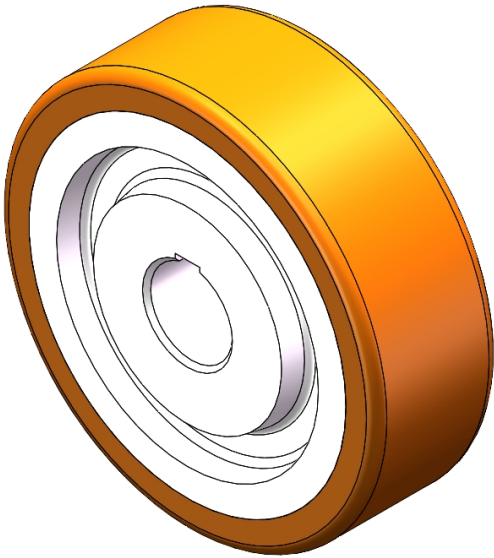

Picture may differ from original product

Technical Data

<input checked="" type="radio"/> Metric <input type="radio"/> Imperial	
Wheel Diameter (D)	185mm
Wheel Width (T2)	60mm
Wheel installation — Hub Lenth (T1)	60mm
Wheel Mounting Bore Diameter	40mm
Keyway Width	12mm
Wheel Keyway Depth (H)	43.3mm
Load Capacity (Static)	900kgs
Load Capacity at 4 km/h	600kgs
Load Capacity at 6 km/h	510kgs
Load Capacity at 10 km/h	420kgs
Load Capacity at 16 km/h	240kgs
Hardness Of Tread	92±5° Shore A
Temperature	-20°C to +70°C
Tread Pattern	—
Wheel centre/ rim	Cast iron / spray-baked black paint
Non-Marking	Y
Conductive	N/A
Anti	N/A
Weight	7.8kgs
Standard	ISO22883

Advantages at a glance

Rolling Resistance	• • • • •
Operating Noise	• • • • •
Floor Surface Preservation	• • • • •

2D Dimensional Drawing of Drive Wheel

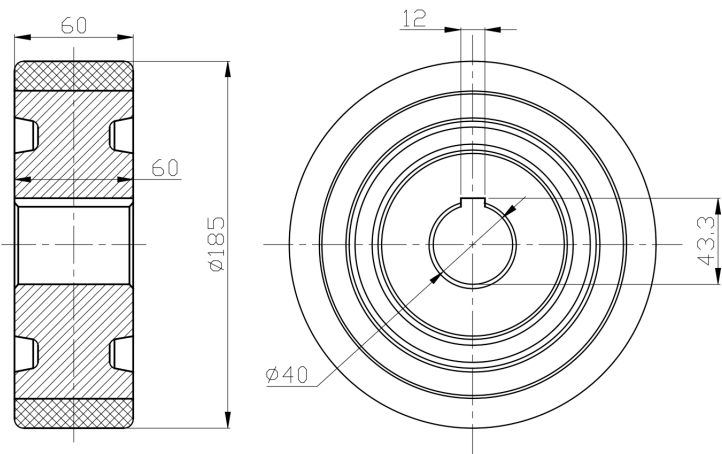

* For any deviation between metric and imperial spec, please refer to the metric spec.