



QPU Series

Wheel Diameter × Wheel Width 185 x 60mm

EAN

YJ-12036357230103

It has good elasticity, reduces pushing resistance, improves machine tool operability, and has good wear resistance.
It has excellent Hydrolysis Resistance.
Suitable for tropical regions and humid working environments.
QPU, brown, Wheel Tread profile: Crown

Wheel Center: Iron core
Wheel Tread: High-quality polyurethane

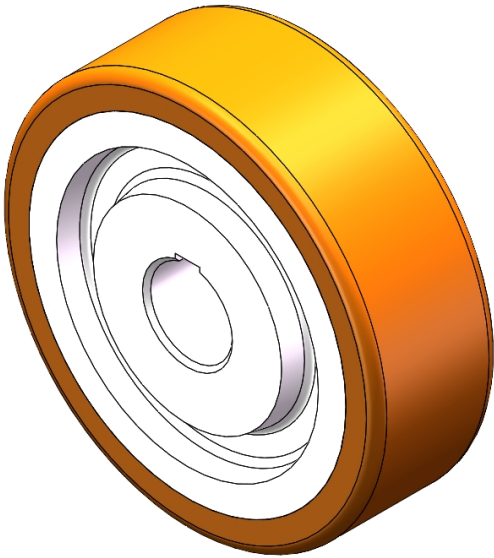

Picture may differ from original product

Technical Data

<input checked="" type="radio"/> Imperial <input type="radio"/> Metric	
Wheel Diameter (D)	7-3/8
Wheel Width (T2)	2-7/16 "
Wheel installation — Hub Lenth (T1)	2-7/16 "
Wheel Mounting Bore Diameter	1-5/8 "
Keyway Width	1/2 "
Wheel Keyway Depth (H)	1-3/4 "
Load Capacity (Static)	1984lbs
Load Capacity at 4 km/h	1323lbs
Load Capacity at 6 km/h	1124lbs
Load Capacity at 10 km/h	926lbs
Load Capacity at 16 km/h	529lbs
Hardness Of Tread	92±5° Shore A
Temperature	-4°F to +158°F
Tread Pattern	—
Wheel centre/ rim	Cast iron / spray-baked black paint
Non-Marking	Y
Conductive	N/A
Anti	N/A
Weight	17.2lbs
Standard	ISO22883

Advantages at a glance

Rolling Resistance	• • • • •
Operating Noise	• • • • •
Floor Surface Preservation	• • • • •

2D Dimensional Drawing of Drive Wheel

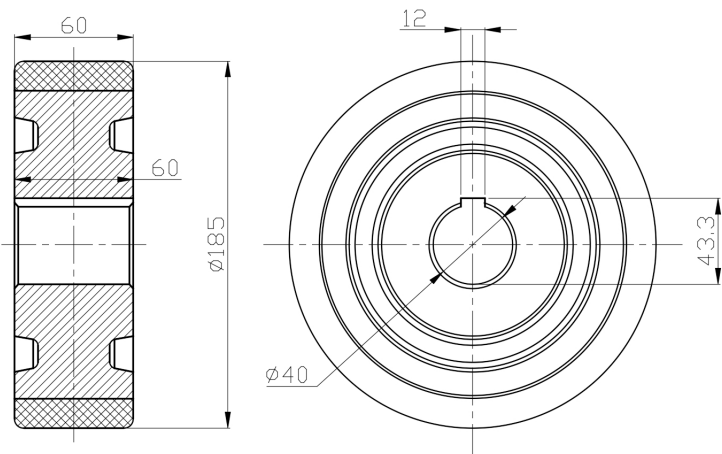

* For any deviation between metric and imperial spec, please refer to the metric spec.