

XPU Series



wheel diameter × wheel width 75 x 114mm

EAN

YJ-12036403480171

It possesses excellent Mechanical Properties, maintaining Heavy Load during high-speed movement, good wear resistance, and is not easily deformed.  
It exhibits excellent resistance to chemicals, solvents, and corrosion.  
Suitable for Forklift Trucks, Electric Stackers, Heavy duty machines, AGVs, and automated industrial applications.  
XPU Burgundy

Wheel Center: Iron core  
Wheel Tread: High-quality polyurethane  
Bearing: Ball bearing

Drawings are for reference only and may differ from the product

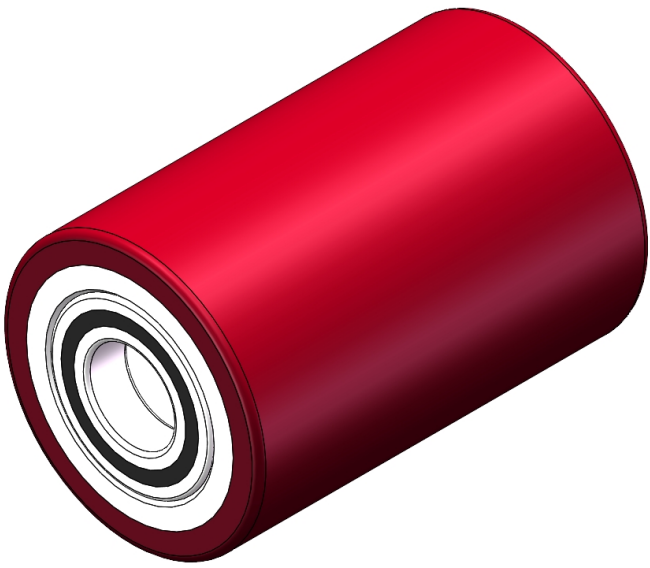

Picture may differ from original product

Technical Data

<input checked="" type="radio"/> Metric <input type="radio"/> Imperial	
Wheel Diameter(D)	75mm
Wheel Width(T2)	114mm
Wheel Bearing	Ball Bearing
Axle Bore(d)	25mm
Axle Bore(S)	—
Bearing Bore Depth(t)	—
Hardness Of Tread	92±5° Shore A
Load Capacity (Dynamic)	640kgs
Load Capacity (Static)	960kgs
Temperature	-20°C to +70°C
Electrical Conductivity	Y
Anti-Static	Y
Weight	1.7kgs
Standard	ISO22883

Advantages at a glance

Rolling Resistance	● ● ● ○ ○
Operating Noise	● ● ● ● ○
Floor Surface Preservation	● ● ● ● ○

2D Dimensional Drawing of Single Wheel

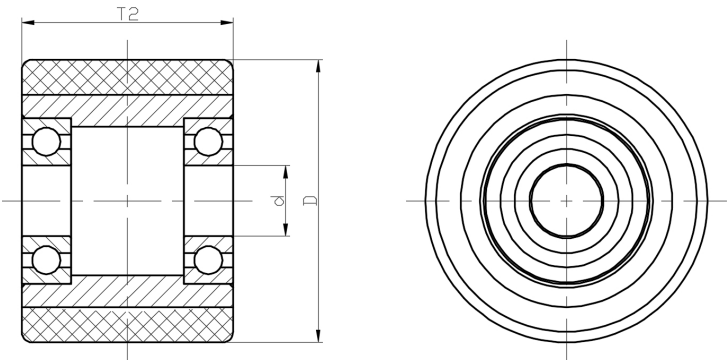

\* For any deviation between metric and imperial spec, please refer to the metric spec.