

NMBR Series



Wheel Diameter × Wheel Width 250 x 50mm

EAN

YJ-12041110206101

Made from High-Quality, elastic, non-greasy, environmentally friendly rubber. Features high Resilient, providing excellent Floor Surface Preservation, Shock-Absorbing, and noise reduction. The non-greasy rubber Non-Markings when walked on. Suitable for any surface. Rubber, natural color, Wheel Tread profile: Crown.

Wheel Center: cast iron core

Outer packaging: rubber

Bearings: —

Drawings are for reference only and may differ from the product

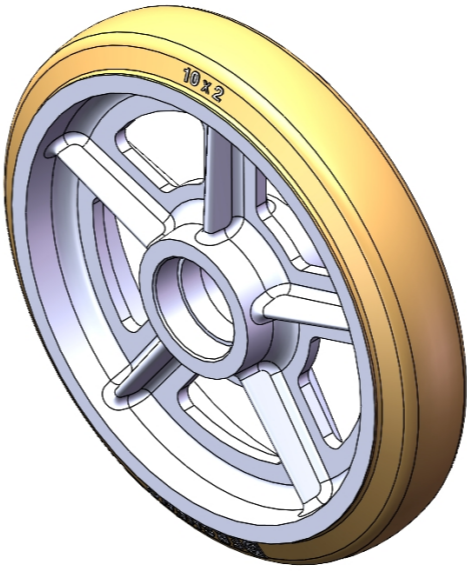

Picture may differ from original product

Technical Data

☒ Metric ☐ Imperial

Wheel Diameter(D)250mm

Wheel Width(T2)50mm

Wheel BearingWithout Bearing

Axle Bore(d)—

Axle Bore(S)52mm

Bearing Bore Depth(t)15mm

Hub Lenth(T1)50mm

Hardness Of Tread60±5° Shore A

Load Capacity (Dynamic)500kgs

Load Capacity (Static)750kgs

Temperature-20°C to +80°C

Electrical ConductivityN/A

Anti-StaticN/A

Weight4.19kgs

StandardISO22883

Advantages at a glance

Rolling Resistance●●●○○

Operating Noise●●●●○

Floor Surface Preservation●●●●○

2D Dimensional Drawing of Single Wheel

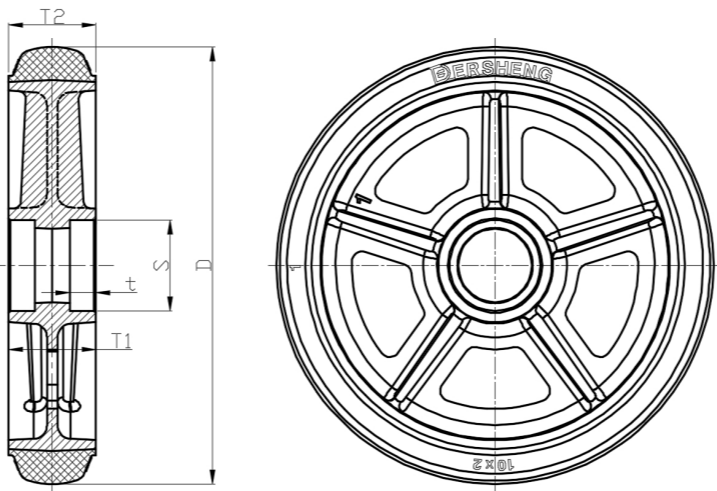

\* For any deviation between metric and imperial spec, please refer to the metric spec.