



1129 Medical Caster Series

Rubber Wheel Diameter × Wheel Width 100 x 30.5mm

EAN

YJ-X11290400064013

Casters with Side Brakes and With locking system. Top Plate with Riveted, Stamping Fork and 75 x 45 mm (3" x 1-3/4") Bolt Hole Spacing.  
Zine-Plated, Mounting Type - Top Plate.  
Reinforced Polypropylene with High-Quality Resilient Rubber Wheel Tread.  
Bearing - Plain Bearing

Wheel surface: high-quality elastic rubber  
Wheel Center: Thermoplastic (PA6)

Drawings are for reference only and may differ from the product

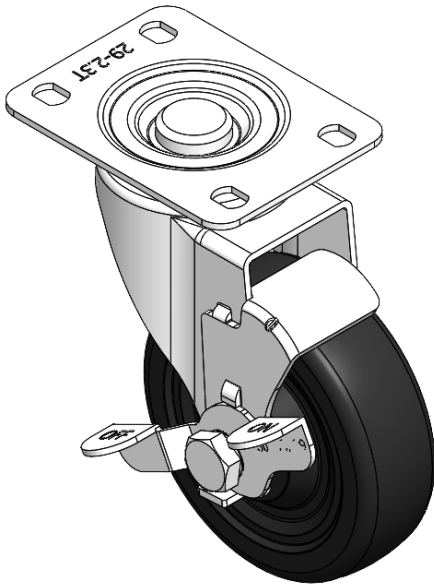

Picture may differ from original product

Technical Data

<input checked="" type="radio"/> Imperial <input type="radio"/> Metric	
Wheel Diameter	4 "
Wheel Width	1-1/4 "
Wheel Bearing	Wheels With Ball Bearings
Plate Size	3-13/16 " x 2-7/8 "
Bolt Hole Spacing	3 " x 1-13/16 "
Plate Hole	1/2 " x 3/8 "
Offset	1-5/8 "
Swivel Interference	7-1/8 "
Overall Height	5-1/2 "
Swivel Radius	3-9/16 "
Hardness Of Tread	80±5° Shore A
Load Capacity (Dynamic)	331lbs
Load Capacity (Static)	496lbs
Temperature	-4°F to +248°F
Fork Type	Swivel Caster With Side Brake
Stainless	N/A
Electrical Conductivity	N/A
Anti-Static	N/A
Weight	1.9lbs
Standard	ISO22883

Advantages at a glance

Rolling Resistance	● ● ● ○ ○
Operating Noise	● ● ● ● ○
Floor Surface Preservation	● ● ● ● ○

Dimensions

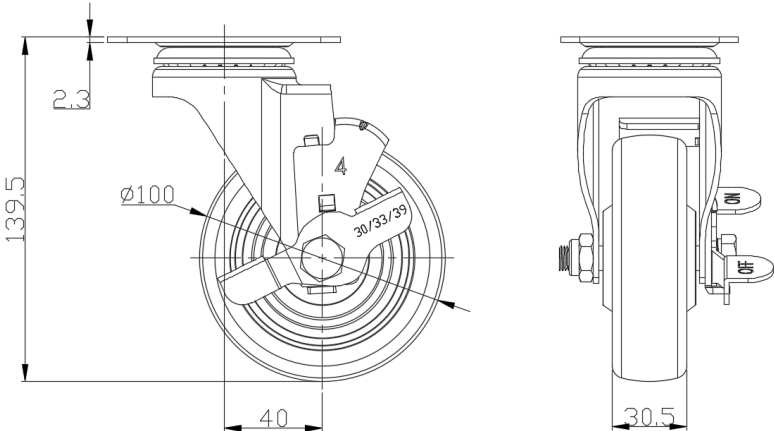

Mounting

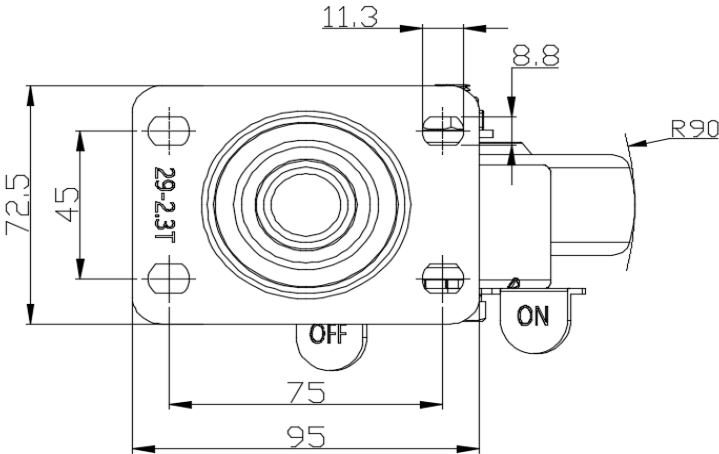

\* For any deviation between metric and imperial spec, please refer to the metric spec.